

Greensboro, NC | 1129 S. Holden Street 27407 NE Corner or Patterson Street and Holden Street

1.78 acre site for sale | \$550,000

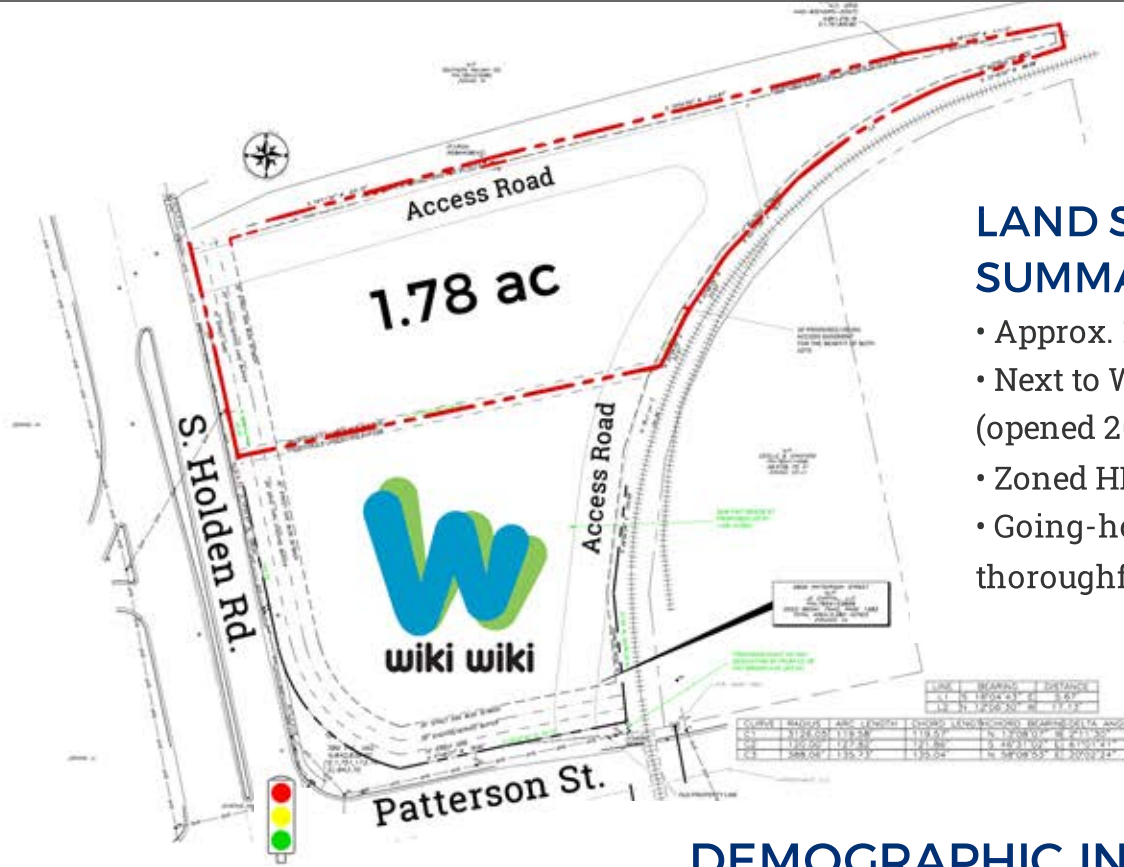

LAND SITE SUMMARY:

- Approx. 1.78 acre site
- Next to Wiki Wiki Car Wash (opened 2016)
- Zoned HI (Heavy Industrial)
- Going-home side of major thoroughfare

DEMOGRAPHIC INFORMATION:

Traffic counts - 2013 NCDOT AADT:

S. Holden, north of site 25,000
S. Holden, south of site 24,000
Patterson St, east of site 9,000
Patterson St, west of site 13,000

	1-mile	3 mile	5 mile
2015 Population	9,395	85,229	194,687
2015 Households	3,926	34,964	81,665
2015 Employees	7,482	81,913	163,729
2015 Average HH Income	\$41,682	\$54,686	\$60,606

The info contained herein was obtained from sources believed to be reliable; however Sterling Properties Group, Inc. makes no guarantees, warranties, or representations as to the completeness or accuracy thereof. The presentation of this property is submitted subject to errors, omissions, changes of price or conditions prior to sale or lease, or withdrawal without notice.

TO LEARN MORE, CONTACT matt.wall@sterlingpropertiesgroup.com

7227 Pineville Matthews Road, Suite 600 | Charlotte, NC 28226 | 704-541-0901 | sterlingpropertiesgroup.com